



# CHECK VALVE

## MODEL CK3MG

### HIGH-CAPACITY DISK TYPE CHECK VALVE WITH CENTER GUIDED VALVE DISC

#### Features

All stainless steel check valve for steam and water.

1. Fine-machined metal valve seat provides tight closure.
2. Stainless steel body and internal parts ensure long service life.
3. Smooth movement of the center guided valve disc further increases durability.
4. Low pressure drop due to large flow area.
5. Performance assured with installation in either horizontal or vertical pipelines.



#### Specifications

Model	CK3MG
Connection	Screwed
Size (mm)	25, 40, 50, 80
Sealing Surface*	Stainless Steel
Maximum Operating Pressure (MPaG) PMO	2.1
Minimum Operating Differential Pressure** (MPa)	0.001
Maximum Operating Temperature (°C) TMO	220
Applicable Fluids***	Steam, Water

\* Perfect sealing cannot be guaranteed for metal sealing surfaces.

1 MPa = 10.197 kg/cm<sup>2</sup>

\*\* When the valve has remained closed for a long period of time, the valve and the valve seat may stick, increasing the necessary minimum operating differential pressure.

\*\*\* Do not use for toxic, flammable or otherwise hazardous fluids.

PRESSURE SHELL DESIGN CONDITIONS (**NOT** OPERATING CONDITIONS): Maximum Allowable Pressure (MPaG) PMA: 3.2  
Maximum Allowable Temperature (°C) TMA: 220

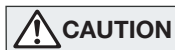

To avoid abnormal operation, accidents or serious injury, DO NOT use this product outside of the specification range. Local regulations may restrict the use of this product to below the conditions quoted.

No.	Description	Material	JIS	ASTM/AISI*
①	Valve Body	Cast Stainless Steel	—	A351 Gr.CF8
②	Inlet Union	Cast Stainless Steel	—	A351 Gr.CF8
③ <sup>R</sup>	Valve Disc	Stainless Steel	SUS304	AISI304
④ <sup>R</sup>	Coil Spring	Stainless Steel	SUS304	AISI304
⑤ <sup>MR</sup>	Union Gasket	Fluorine Resin	PTFE	PTFE
⑥	Nameplate	Stainless Steel	SUS304	AISI304

\* Equivalent

Replacement kits available: (M) maintenance parts, (R) repair parts  
When requesting replacement kits, please specify the Minimum Opening Differential Pressure.

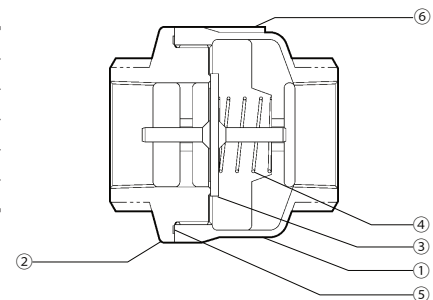

**Dimensions**

● **CK3MG** Screwed

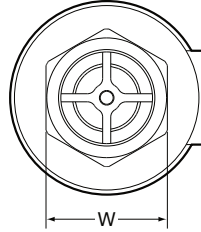
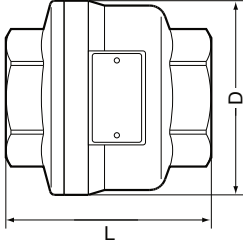

**CK3MG** Screwed\* (mm)

Size	L	$\phi$ D	W	Weight (kg)
25	84	70	41	1.0
40	122	102	60	2.8
50	127	120	75	3.7
80	171	151	100	5.5

\* Rc(PT), other standards available

**Cv Values**

Size (mm)	25	40	50	80
Cv (US)	25	55	91	180
Cv (UK)	21	46	76	150
Kvs (DIN)	21	47	78	154

Manufacturer  
**TLV** CO., LTD.  
 Kakogawa, Japan  
is approved by LRQA Ltd. to ISO 9001/14001

ISO 9001  
 ISO 14001

